

To Whom It May Concern:

I, Alice R. Scheeff, owner of parcel #236-24-020, give Ronald A. DeLorenzo permission to represent me in requesting rezoning of my property for Biddulph Trails Subdivision.

*Alice R. Scheeff*

Alice R. Scheeff      Date



HOME | CONTACT | CUYAHOGA COUNTY HOME

CUYAHOGA COUNTY AUDITOR  
**Frank Russo**

Real Property Information

General Information | Transfer History | Land Record | Residential Bldg Sketch | Taxes/Gen Values | Search Page



PARCEL ID 236-24-020  
 OWNERS NAME SCHEEFF, ALICE R. TRS  
 ADDRESS COLUMBIA RD  
 CITY NORTH OLMSTED  
 ZIP 44070

[Field Definitions](#)

**Land Record**

RECORD NUMBER	1	EFFECTIVE FRONT	192.1
LAND TYPE	PRM	AVG DEPTH	
LEGAL FRONT	192.1	LOT SIZE (SQFT.)	10,907
LEGAL DEPTH	115.3		

CUYAHOGA COUNTY ASSUMES NO LIABILITY FOR DAMAGES AS A RESULT OF ERRORS, OMISSIONS OR DISCREPANCIES CONTAINED IN THESE PAGES. PROSPECTIVE PURCHASERS SHOULD CONSULT A REAL ESTATE ATTORNEY AND PURCHASE A TITLE INSURANCE POLICY PRIOR TO THE SALE.

**RECEIVED**  
 OCT 07 2008  
 PLANNING DEPARTMENT



# Cuyahoga County Enterprise GIS

Street Aerial ⓘ

CEGIS Prototype Departments Services Attractions FAC

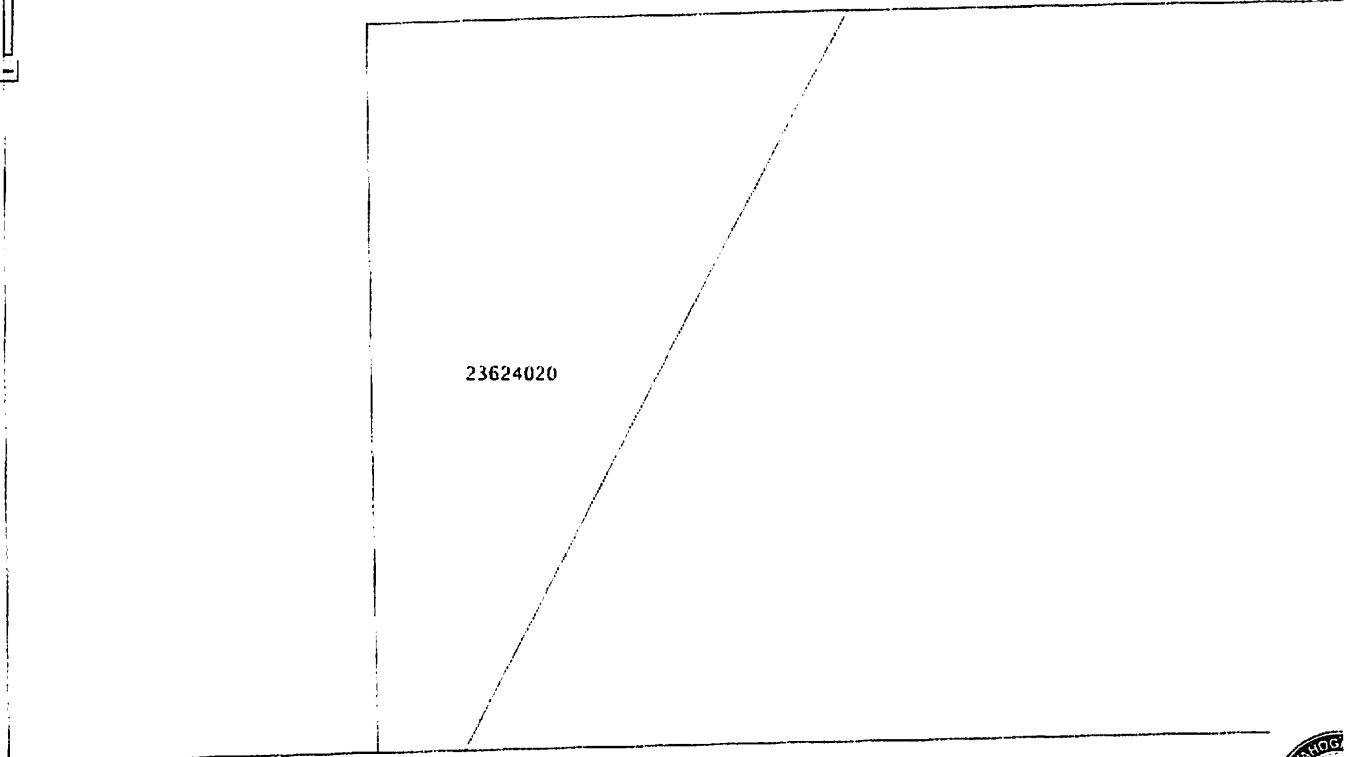

23624020

50 ft  
10 m



Location (in Ohio North SPCS (Feet):2131148.8, 632971.4

**RECEIVED**  
OCT 07 2008  
PLANNING DEPARTMENT

HOME CONTACT CUYAHOGA COUNTY HOME

CUYAHOGA COUNTY AUDITOR  
**Frank Russo**



### Real Property Information

- General Information
- Transfer History
- Land Record
- Residential Bldg. Sketch
- Taxes/Cert. Values
- Search Page

PRIMARY OWNER SCHEEFF, ALICE R. TRS  
 PROPERTY ADDRESS Columbia Rd, North Olmsted, OH 44070  
 TAX MAILING ADDRESS SCHEEFF, ALICE R. TRS, 6001 PEBBLEBROOK Ln, NORTH OLMSTED, OH 44070  
 LEGAL DESCRIPTION 6-27 NP 1160FT SP TRICOLUMBIA RD IN REAR  
 PROPERTY CLASS GOLF COURSES

[Field Definitions](#)

### 2008 (pay in 2009) TAXBILL SUMMARY

PARCEL NUMBER 236-24-020 TAXSET North Olmsted TAX YEAR 2008 (pay in 2009) ▼

FLAGS		ESCROW	
2.5% RED.	N	ESCROW	N
HOMESTEAD	N	PMT. AMOUNT	0.00
FORECLOSURE	N	ACCOUNT	
CERT. PEND.	N		
CERT. SOLD	N		
PAYMENT PLAN	N		

No charges and payments are found for this parcel and tax year.

CUYAHOGA COUNTY ASSUMES NO LIABILITY FOR DAMAGES AS A RESULT OF ERRORS, OMISSIONS OR DISCREPANCIES CONTAINED IN THESE PAGES. PROSPECTIVE PURCHASERS SHOULD CONSULT A REAL ESTATE ATTORNEY AND PURCHASE A TITLE INSURANCE POLICY PRIOR TO THE SALE.

© CUYAHOGA COUNTY AUDITOR'S OFFICE

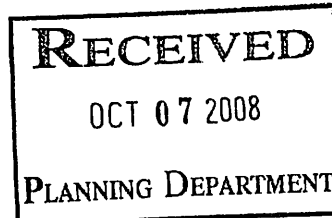

HOME | CONTACT | CUYAHOGA COUNTY HOME | **CUYAHOGA COUNTY AUDITOR**  
**Frank Russo** 

Real Property Information

General Information | Transfer History | **Land Record** | Residential Bldg. Sketch | Taxes / Cert. Values | Search Page

PARCEL ID **236-23-017**  
 OWNERS NAME BUTTERNUT RIDGE PROP LTD.,  
 ADDRESS BUTTERNUT RIDGE RD  
 CITY NORTH OLMSTED  
 ZIP 44070

[Field Definitions](#)

**Land Record**

RECORD NUMBER	1	EFFECTIVE FRONT	23.3
LAND TYPE	PRM	AVG DEPTH	
LEGAL FRONT	23.3	LOT SIZE (SQFT.)	297,950
LEGAL DEPTH			

CUYAHOGA COUNTY ASSUMES NO LIABILITY FOR DAMAGES AS A RESULT OF ERRORS, OMISSIONS OR DISCREPANCIES CONTAINED IN THESE PAGES. PROSPECTIVE PURCHASERS SHOULD CONSULT A REAL ESTATE ATTORNEY AND PURCHASE A TITLE INSURANCE POLICY PRIOR TO THE SALE.

**RECEIVED**  
 OCT 07 2008  
 PLANNING DEPARTMENT



# Cuyahoga County Enterprise GIS

Street Aerial CEGIS Prototype Departments Services Attractions FAC



Firefox

Location (in Ohio North SPCS (Feet):2131107.1, 633929.8

**RECEIVED**  
 OCT 07 2008  
 PLANNING DEPARTMENT

HOME | CONTACT | CUYAHOGA COUNTY HOME

CUYAHOGA COUNTY AUDITOR  
**Frank Russo**

Real Property Information

General Information | Transfer History | Land Record | Residential Bldg. Sketch | Taxes/Cert. Values | Search Page



PRIMARY OWNER Butternut Ridge Prop Ltd.,  
 PROPERTY ADDRESS Butternut Ridge Rd, North Olmsted, OH 44070  
 TAX MAILING ADDRESS 4BRD-Bonita A. Delorenzo Trs., 26005 Butternut Ridge Rd, North Olmsted, OH 44070-4514  
 LEGAL DESCRIPTION 27 NWP 2152FT NW OF COLUMBIA RD 308.74FT IN REAR EST 1400D  
 PROPERTY CLASS GOLF COURSES

[Field Definitions](#)

**2008 (pay in 2009) TAXBILL SUMMARY**

PARCEL NUMBER 236-23-017 TAXSET North Olmsted TAX YEAR 2008 (pay in 2009) ▼

FLAGS	ESCROW
2.5% RED. N	ESCROW N
HOMESTEAD N	PMT. AMOUNT 0.00
FORECLOSURE N	ACCOUNT
CERT. PEND. N	
CERT. SOLD N	
PAYMENT PLAN N	

No charges and payments are found for this parcel and tax year.

CUYAHOGA COUNTY ASSUMES NO LIABILITY FOR DAMAGES AS A RESULT OF ERRORS, OMISSIONS OR DISCREPANCIES CONTAINED IN THESE PAGES. PROSPECTIVE PURCHASERS SHOULD CONSULT A REAL ESTATE ATTORNEY AND PURCHASE A TITLE INSURANCE POLICY PRIOR TO THE SALE.

© CUYAHOGA COUNTY AUDITOR'S OFFICE

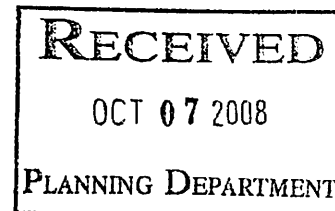

HOME | CONTACT | CUYAHOGA COUNTY HOME

**CUYAHOGA COUNTY AUDITOR**  
**Frank Russo**

General Information | Transfer History | Land Record | Residential Bldg Sketch | Taxes/Cert. Values | Search Page



PARCEL ID **236-24-019**  
 OWNERS NAME BUTTERNUT RIDGE PROP LTD.,  
 ADDRESS COLUMBIA RD  
 CITY NORTH OLMSTED  
 ZIP 44070

[Field Definitions](#)

**Land Record**

RECORD NUMBER	1	EFFECTIVE FRONT	385
LAND TYPE	PRM	AVG DEPTH	
LEGAL FRONT	385	LOT SIZE (SQFT.)	87,555
LEGAL DEPTH	233.7		

CUYAHOGA COUNTY ASSUMES NO LIABILITY FOR DAMAGES AS A RESULT OF ERRORS, OMISSIONS OR DISCREPANCIES CONTAINED IN THESE PAGES. PROSPECTIVE PURCHASERS SHOULD CONSULT A REAL ESTATE ATTORNEY AND PURCHASE A TITLE INSURANCE POLICY PRIOR TO THE SALE.

**RECEIVED**  
 OCT 07 2008  
 PLANNING DEPARTMENT





# Cuyahoga County Enterprise GIS

Street Aerial

CEGIS Prototype Departments Services Attractions FAC

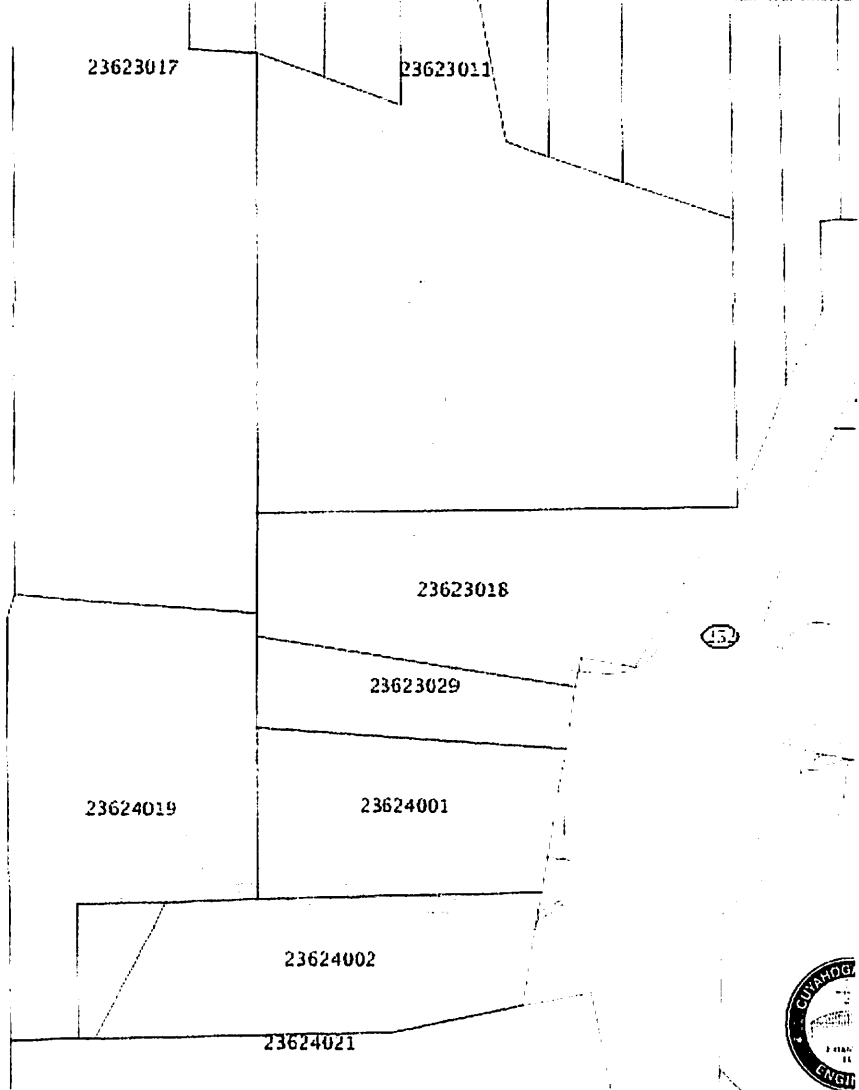
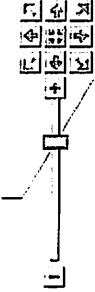

200 ft  
50 m



Location (in Ohio North SPCS (Feet)):2131283.1, 633059.2

**RECEIVED**  
 OCT 07 2008  
 PLANNING DEPARTMENT

HOME | CONTACT | CUYAHOGA COUNTY HOME

**CUYAHOGA COUNTY AUDITOR**

**Frank Russo**



General Information | Transfer History | Land Record | Residential Bldg. Sketch | Taxes/Cert. Values | Search Page

PRIMARY OWNER Butternut Ridge Prop Ltd.,  
 PROPERTY ADDRESS Columbia Rd, North Olmsted, OH 44070  
 TAX MAILING ADDRESS 4BRD-Bonita A. Delorenzo Trs., 26005 Butternut Ridge Rd, North Olmsted, OH 44070-4514  
 LEGAL DESCRIPTION TR 6-27 WP 749.43FT WOF CL COLUMBIA RD COLUMBIA RD IN REAR  
 PROPERTY CLASS GOLF COURSES

[Field Definitions](#)

**2008 (pay in 2009) TAXBILL SUMMARY**

PARCEL NUMBER 236-24-019 TAXSET North Olmsted TAX YEAR 2008 (pay in 2009) ▼

FLAGS		ESCROW	
2.5% RED.	N	ESCROW	N
HOMESTEAD	N	PMT. AMOUNT	0.00
FORECLOSURE	N	ACCOUNT	
CERT. PEND.	N		
CERT. SOLD	N		
PAYMENT PLAN	N		

No charges and payments are found for this parcel and tax year.

CUYAHOGA COUNTY ASSUMES NO LIABILITY FOR DAMAGES AS A RESULT OF ERRORS, OMISSIONS OR DISCREPANCIES CONTAINED IN THESE PAGES. PROSPECTIVE PURCHASERS SHOULD CONSULT A REAL ESTATE ATTORNEY AND PURCHASE A TITLE INSURANCE POLICY PRIOR TO THE SALE.

© CUYAHOGA COUNTY AUDITOR'S OFFICE

**RECEIVED**  
 OCT 07 2008  
 PLANNING DEPARTMENT

HOME | CONTACT | CUYAHOGA COUNTY HOME

**CUYAHOGA COUNTY AUDITOR**  
**Frank Russo**

Real Property Information

General Information | Transfer History | Land Record | Residential Bldg Sketch | Taxes Cert Values | Search Page



PARCEL ID 236-23-028  
 OWNERS NAME BRADFORD, JULIE P.  
 ADDRESS 25747 BUTTERNUT RIDGE RD  
 CITY NORTH OLMSTED  
 ZIP 44070

[Field Definitions](#)

**Land Record**

RECORD NUMBER	1	EFFECTIVE FRONT	120
LAND TYPE	PRM	AVG DEPTH	370
LEGAL FRONT	127.1	LOT SIZE (SQFT.)	44,400
LEGAL DEPTH	370		

CUYAHOGA COUNTY ASSUMES NO LIABILITY FOR DAMAGES AS A RESULT OF ERRORS, OMISSIONS OR DISCREPANCIES CONTAINED IN THESE PAGES. PROSPECTIVE PURCHASERS SHOULD CONSULT A REAL ESTATE ATTORNEY AND PURCHASE A TITLE INSURANCE POLICY PRIOR TO THE SALE.

**RECEIVED**  
 OCT 07 2008  
 PLANNING DEPARTMENT



# Cuyahoga County Enterprise GIS

Street Aerial   CEGIS Prototype Departments Services Attractions FAC

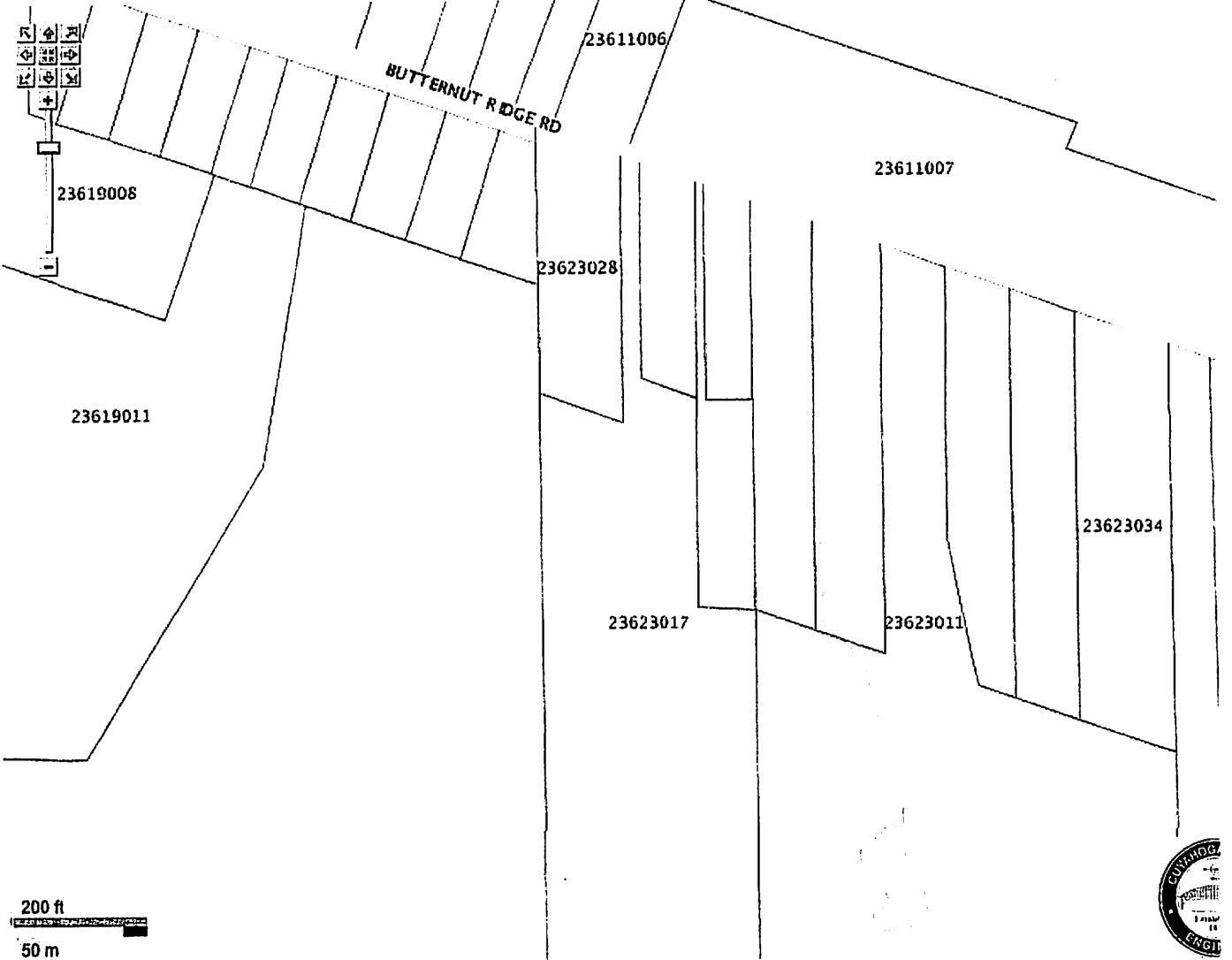

Location (in Ohio North SPCS (Feet):2131107.1, 633929.8

**RECEIVED**  
 OCT 07 2008  
 PLANNING DEPARTMENT

HOME | CONTACT | CUYAHOGA COUNTY HOME

**CUYAHOGA COUNTY AUDITOR**  
**Frank Russo**

Real Property Information

General Information | Transfer History | Land Record | Residential Bldg. Sketch | Taxes / Cert. Values | Search Page



PRIMARY OWNER Bradford, Julie P.  
 PROPERTY ADDRESS 25747 Butternut Ridge Rd, North Olmsted, OH 44070  
 TAX MAILING ADDRESS FAR-First American Real Estate Tax Service, 1721 Moon Lake Blvd, Suite 400, Hoffman Estates, IL 60194  
 LEGAL DESCRIPTION 27 NWP 2280.93FT NW OF COLUMBIA RD [Field Definitions](#)  
 PROPERTY CLASS SINGLE FAMILY DWELLING

**2008 (pay in 2009) TAXBILL SUMMARY**

PARCEL NUMBER 236-23-028 TAXSET North Olmsted TAX YEAR 2008 (pay in 2009) ▼

<u>FLAGS</u>		<u>ESCROW</u>	
2.5% RED.	N	ESCROW	N
HOMESTEAD	N	PMT. AMOUNT	0.00
FORECLOSURE	N	ACCOUNT	
CERT. PEND.	N		
CERT. SOLD	N		
PAYMENT PLAN	N		

No charges and payments are found for this parcel and tax year.

CUYAHOGA COUNTY ASSUMES NO LIABILITY FOR DAMAGES AS A RESULT OF ERRORS, OMISSIONS OR DISCREPANCIES CONTAINED IN THESE PAGES. PROSPECTIVE PURCHASERS SHOULD CONSULT A REAL ESTATE ATTORNEY AND PURCHASE A TITLE INSURANCE POLICY PRIOR TO THE SALE.

© CUYAHOGA COUNTY AUDITOR'S OFFICE

**RECEIVED**  
 OCT 07 2008  
 PLANNING DEPARTMENT